

## Designer Hood Chimney

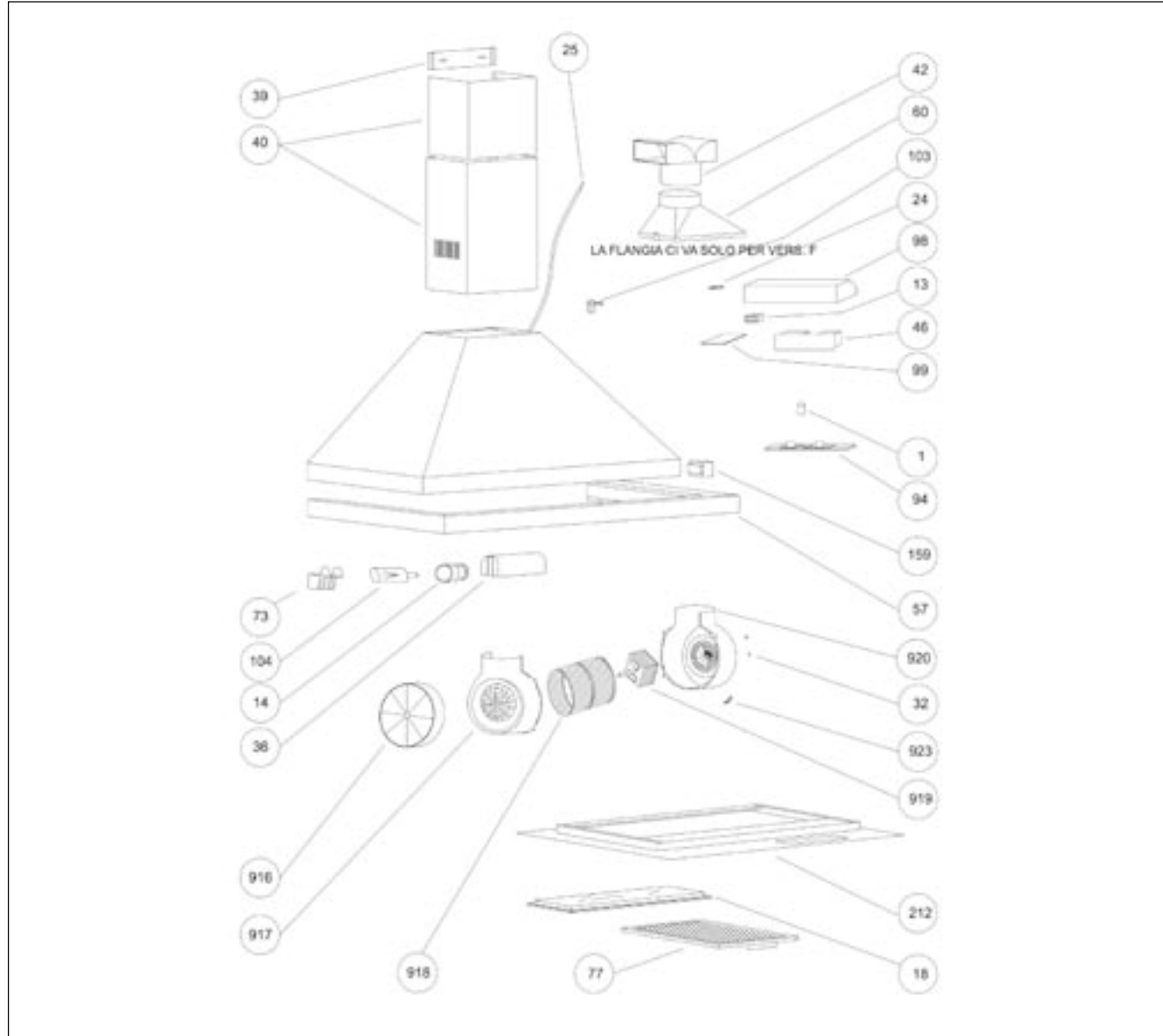

Designer Hood Chimney T1 NEW (1250 M3, 60 & 90)		
Ref. No.	Spare Part Name	SAP Code
1	CH TUBE SET T1	60000007
2	MOTOR WITH HOUSING T1	50000197
3	CARBON FILTER T1	50001198
4	CASSETTE FILTER	50000008
5	CASSETTE FILTER LOCK PLATED	50000061
6	CHIMNEY HOOD	50000039
7	LAMP HOLDER -	50000236
8	PCB T1	50000121
9	SWITCH HOUSING COVER- BOTTOM	50000240
10	SWITCH HOUSING COVER- TOP	50000241
13	PUSH BUTTON KNOB PLATED SET OF 4 PCS GL	40000126
11	SPIGOT T1/T4	40000120
12	S406 MOTOR T1	40000119
13	Condensor Motor	50000002
14	CANDLE BULB	40000022
15	MOTOR FAN T1	40000107
16	LAMP LENS	50000084
17	TERMINAL BOX T1	50000231

Designer Hood Chimney (750/890 M3, 60 & 90)		
Ref. No.	Spare Part Name	SAP Code
918	FAN T4	50000052
46	PCB 750	40000169
3	ALUM.DEFLECTOR	50000238
4	CARBON FILTER T4	50001198
5	CASSETTE FILTER T4	50000008
6	CASSETTE FILTER LOCK PLATED	50000061
7	CHIMNEY HOOD	50000039
8	LAMP HOLDER -	50000236
9	MOTOR T4	50000102
10	LAMP HOLDER CLAMP T4	40001368
13	MOTOR HOUSING T4	40001367
11	MOTOR SUPPORT T4	40001370
12	SPIGOT T1/T4 GL	40000120
13	SS BAFFLE FILTER	40000037
	SS BAFFLE FILTER II	
14	CANDLE BULB	40000022
15	Lock for SS Baffle Filter	50000097
16	PUSH BUTTON KNOB PLATED SET OF 4 PCS GL	40000126
17	LAMP LENS	50000084